

In dieser Lage kann die Position der Passfedernut zum Bohrbild  $\pm 1,5^\circ$  abweichen  
 In this situation can the keyway position varying  $\pm 1,5^\circ$  to the drilling pattern

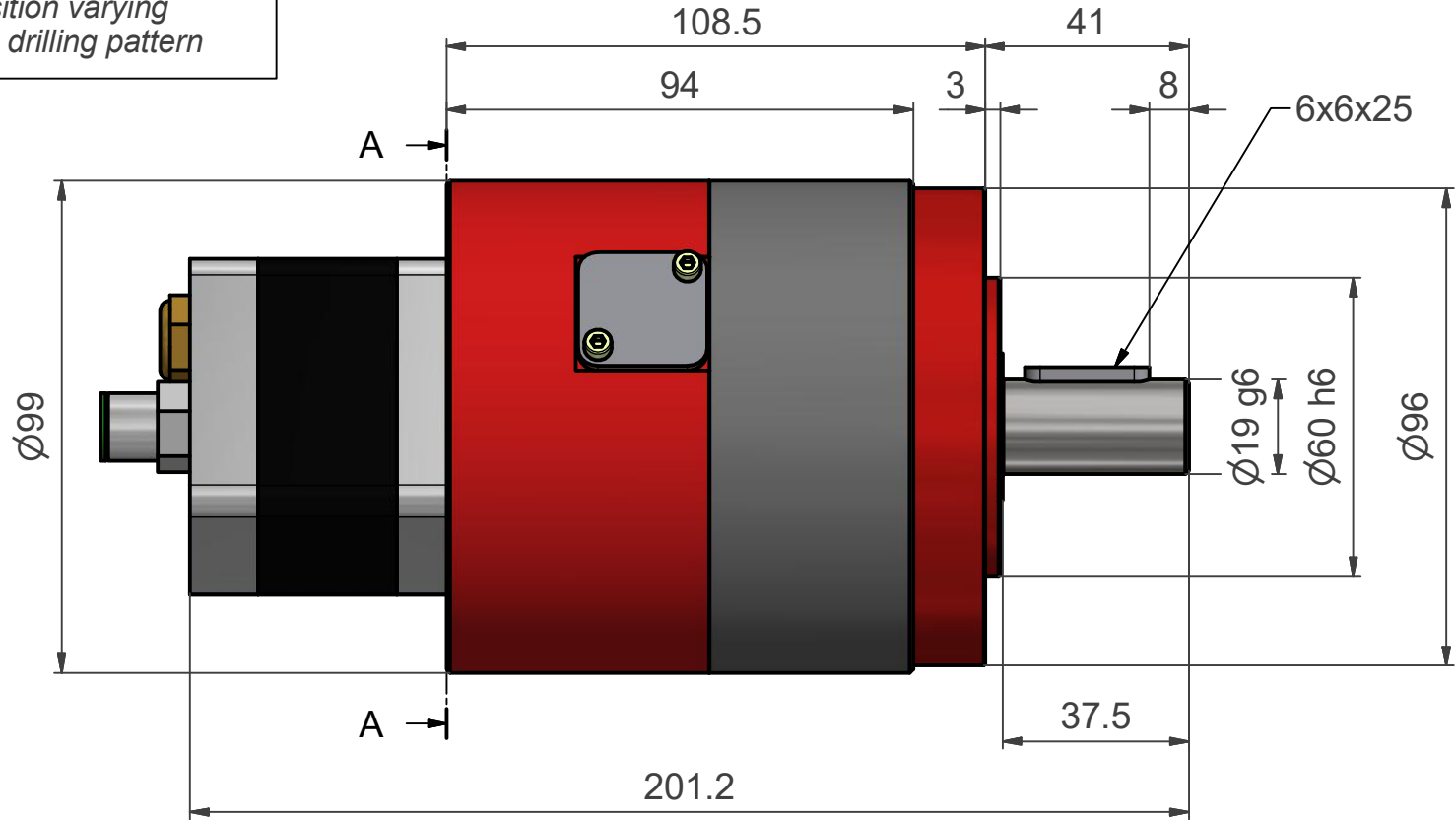

**Schnitt A-A (1 : 1.5)**

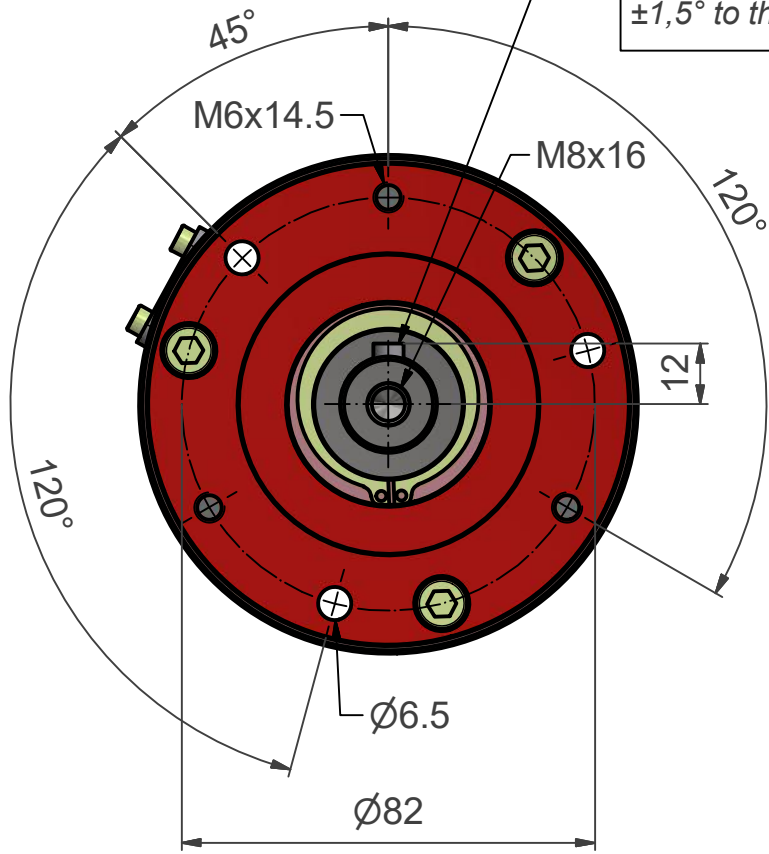
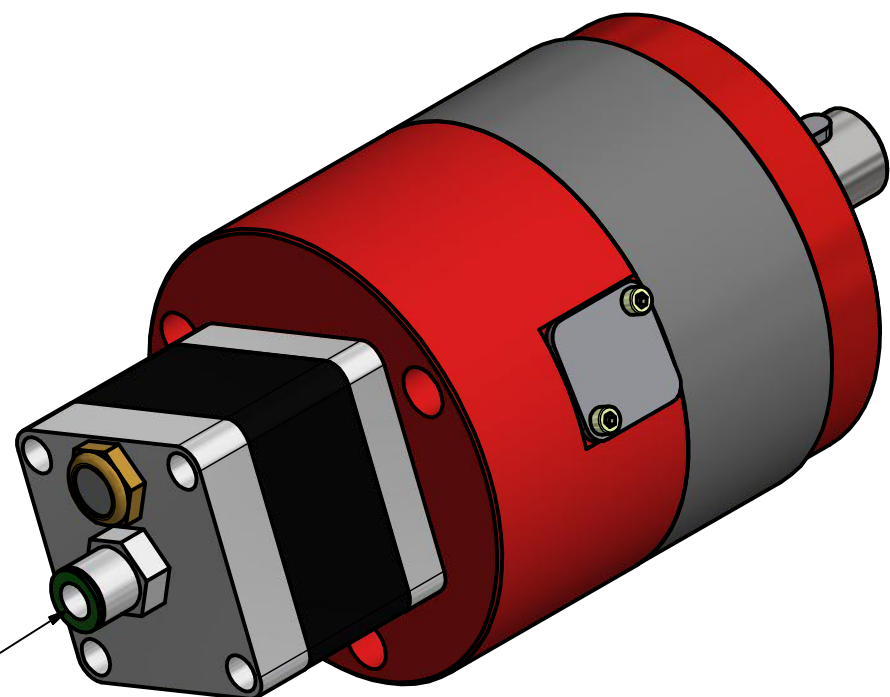
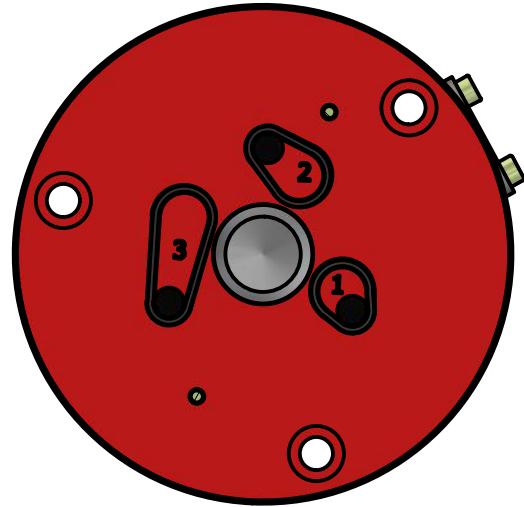

für Schlauch  $\varnothing 8$  mm  
 for hose  $\varnothing 8$  mm

|   |               |            |            |     |
|---|---------------|------------|------------|-----|
| Gegenstand<br>Schrittmotor<br>BPS-2532-MX | Massstab      | Gezeichnet | 16.01.2018 | rsc |
|   | 1 : 1.5       | Geprüft    |            |     |
|   |               | Gesehen    |            |     |
| Nummer                                    | Blatt 1 von 1 |            | Format     |     |
| 500-25-382                                |               |            | A3         |     |